

# HSF

**NOTES:**

Current Rating: 3.0AMP  
 Contact Resistance: 20mΩ Max  
 Withstand Voltage: 800V AC/DC  
 Insulation Resistance: 1000MΩ Min  
 Operation Temperature: -25°C to +85°C  
 Contact Material: Brass  
 Contact plating: Au Or Sn over Ni  
 Insulator Material: PA66 UL94V-0

## Ordering Information

WF2501A - WS XX W 0 1

H=PA66 No. of pins Contact Plating  
 Blank=PA66 02-15P G0=Gold Flash  
 G3=10u"Gold  
 G4=15u"Gold  
 G5=30u"Gold  
 Blank=Fin

Color  
 B=Black  
 W=White

Packaging  
 0=PE Bag  
 T=Tube

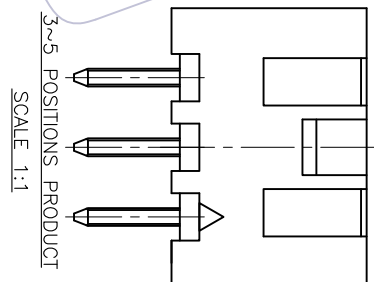
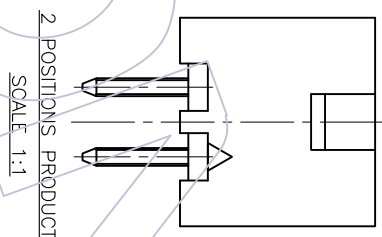
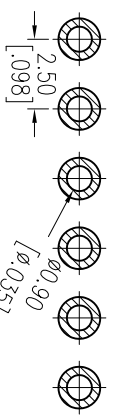
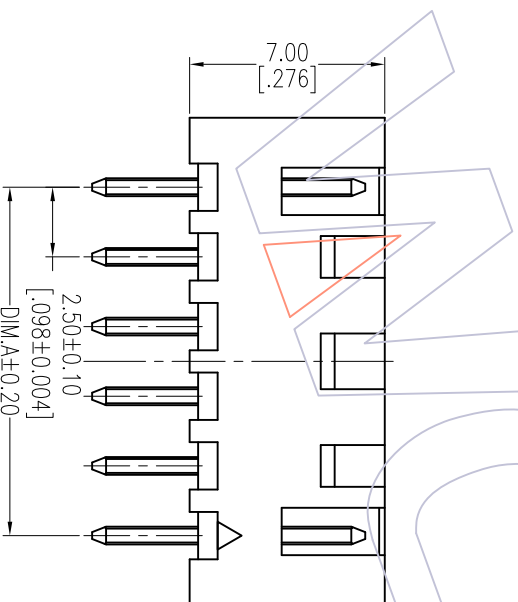
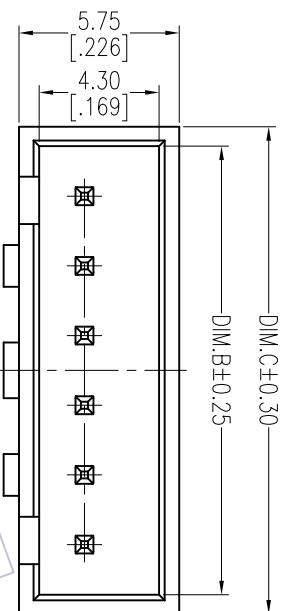

No. Of POSITION	DIM. A	DIM. B	DIM. C
02	2.50	6.10	7.48
03	5.00	8.60	9.98
04	7.50	11.10	12.48
05	10.00	13.60	14.98
06	12.50	16.10	17.48
07	15.00	18.60	19.98
08	17.50	21.10	22.48
09	20.00	23.60	24.98
10	22.50	26.10	27.48
11	25.00	28.60	29.98
12	27.50	31.10	32.48
13	30.00	33.60	34.98
14	32.50	36.10	37.48
15	35.00	38.60	39.98

Recommended P.C.B Layout(Top Side)  
 (PCB BOARD TOLERANCE ±0.05)

OPERATION DRAW DATE SCALE FIT PART NO.  
 XX ±0.40 JYHuang 2013/06/25 mm A4 WF2501A-WSXXW01

CHECK DATE SHEET SIZE TITLE:  
 XXXX ±0.15 1/1 2.50 PITCH 180° DIP TYPE  
 SING ROW WAFER

APPROVE DATE PROJ. Customer NO.

**WCON**  
 Http: www.wcon.com

REV	DATE	MODIFICATION DESCRIPTION	CHANGE
A0	2013/06/25	NEW	-----

WCON-Dongguan Tel: +86 769 85358920 Fax: +86 769 85358915 E-mail: sales@wcon.com  
 WCON-Kunshan Tel: +86 512 57468408 Fax: +86 512 57468468 E-mail: sales@wcon.com