

# HSF

**NOTES:**

Current Rating: 3.0AMP  
 Contact Resistance: 20mΩ Max  
 Withstand Voltage: 500V AC/DC  
 Insulation Resistance: 1000MΩ Min  
 Operation Temperature: -55°C to +105°C

Contact Material: Phosphor Bronze/Brass  
 Contact plating: SeI, Au over Ni  $\Delta\Delta$   
 Insulator Material: PBT+30%G, F UL94V-0  
 Shell: Cold Roller Steel, Ni Plated  
 Nut: Brass, Sn over Ni Plated

## Ordering Information

6224-XX M N XX X 0 X

No. of Pins 09, 15, 25, 37P  
 Contact Plating S0=Gold Flash/Ni B:Black  
 Insulator Color S3=10u"Gold/Ni U:Blue  
 Screw S4=15u"Gold/Ni 1=Without Screw (three part)  
 S5=30u"Gold/Ni 2=With Screw (three part)  
 3=With Screw (two part)  
 4=With Screw (two part)  
 5=With Screw, Don't lock (two part)  
 6=With Screw&Nut, Don't lock (two part)

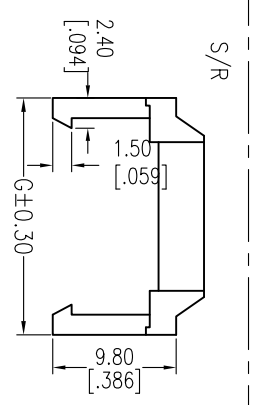
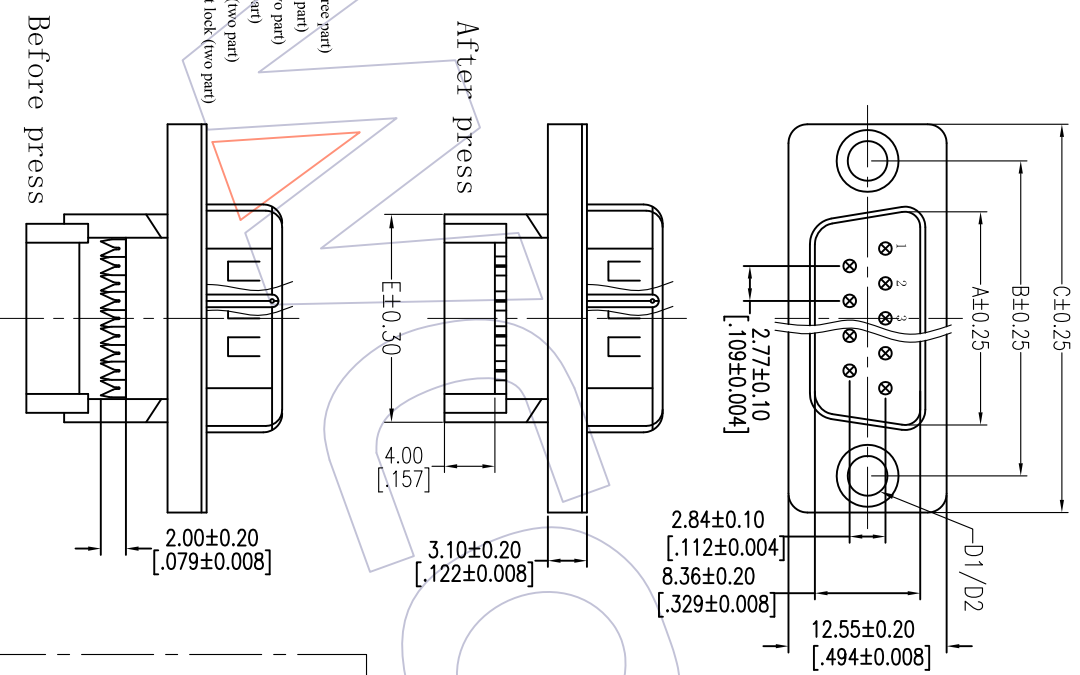

No. of Positions	DIM "A"	DIM "B"	DIM "C"	DIM "D1"	DIM "D2"	DIM "E"	DIM "F"	DIM "G"
09	16.92	24.99	30.81			18.50	15.00	18.80
15	25.25	33.32	39.14			24.80	23.30	26.90
25	38.96	47.04	53.04	Without Screw #3.15	Min Screw #4-40	38.60	37.00	40.50
37	55.42	63.50	69.22			55.20	53.70	57.20

# WCON

Http: www.wcon.com

WCON-Dongguan  
 Tel: +86 769 85358920  
 Fax: +86 769 85358915  
 E-mail: sales@wcon.com

WCON-Kunshan  
 Tel: +86 512 57468408  
 Fax: +86 512 57468468  
 E-mail: sales@wcon.com

REV	DATE	MODIFICATION DESCRIPTION	CHANGE	OPERATION	DRAW	DATE	SCALE	FIT	PART NO.
A1	2015/12/14	Modify $\Delta\Delta$	-----	X.XX ±0.40	JYHuang	2015/12/14	UNIT mm		SEE TABLE
A0	2012/12/06	NEW	-----	X.XXX ±0.15	CHECK	DATE	SIZE A4	1/1	D-SUB MALE DUAL ROW IDC TYPE
REV	DATE	MODIFICATION DESCRIPTION	CHANGE	Angle DIM TOL	APPROVE	DATE	SHEET PROJ.		Customer NO.