

HSF

NOTES:
 Current Rating:5.0A AMP
 Contact Resistance:10milliohm Max
 Withstand Voltage:1000V AC/Minute
 Insulation Resistance:1000Megohm Min
 Operation Temperature:-25°C to +85°C

Housing Material:LCP+30%GF(UL94V-0)
 Contact Material:Copper alloy
 Contact plating:Au/Sn over Ni Plating

RECOMMENDED PCB LAYOUT
 TOLERANCE IS ±0.05

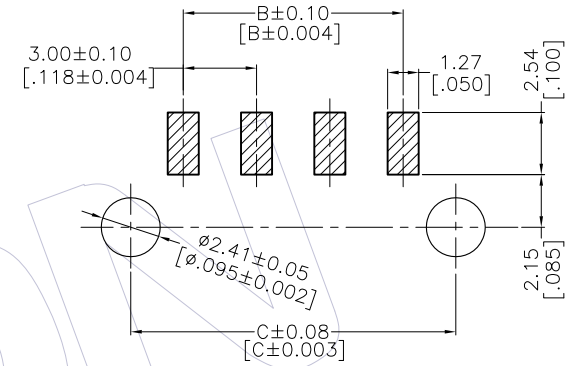
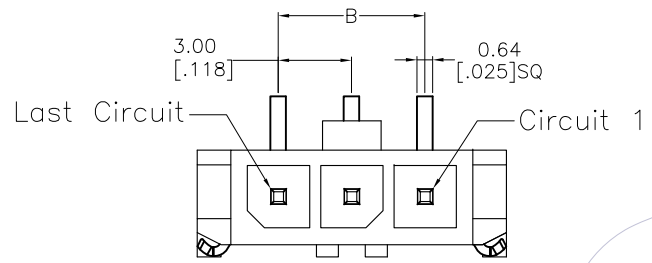

Ordering Information

WF3001-1 WM XX B X 1

Terminal shape: WM:Wafer 180° SMT
 NO.of Pins: 02~12Pin
 Packing: 0=PE Bag, T=Tube, A=Tray, R=Tape&Reel

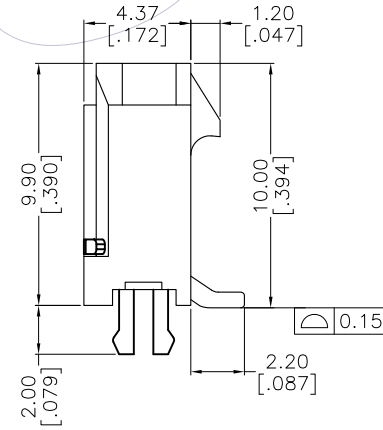
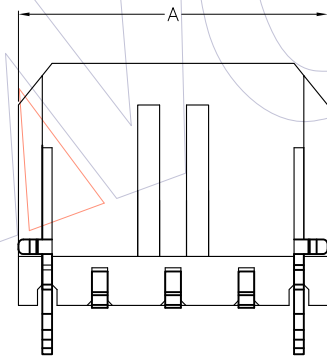

Circuit	A	B	C
02	9.65[0.380]	3.00[0.118]	7.30[0.287]
03	12.65[0.498]	6.00[0.236]	10.30[0.405]
04	15.65[0.616]	9.00[0.355]	13.30[0.524]
05	18.65[0.735]	12.00[0.473]	16.30[0.642]
06	21.65[0.853]	15.00[0.591]	19.30[0.760]
07	24.65[0.971]	18.00[0.709]	22.30[0.878]
08	27.65[1.089]	21.00[0.827]	25.30[0.996]
09	30.65[1.207]	24.00[0.945]	28.30[1.114]
10	33.65[1.325]	27.00[1.063]	31.30[1.232]
11	36.65[1.443]	30.00[1.181]	34.30[1.350]
12	39.65[1.561]	33.00[1.299]	37.30[1.469]

REV	DATE	MODIFICATION DESCRIPTION	CHANGE	OPERATION		DRAW FZY	DATE	SCALE	1:1	PART NO.
				X.X	±0.40					
A1	2012.05.02	料号由WF3001-1WMHXXBX1变更为WF3001-1WMXXBX1	ATOMY	X.XX	±0.25	CHECK	DATE	UNIT	mm	WF3001-1WMXXBX1
A0	2011.12.20	NEW	-	X.XXX	±0.15	APPROVE	DATE	SIZE	A4	
				Angle	± 3'			SHEET	1/1	TITLE:
				DIM	TOL			PROJ.	Customer NO.	

WCON

Http: www.wcon.com

WCON-Dongguan
 Tel: +86 769 85358920
 Fax: +86 769 85358915
 E-mail: sales@wcon.com

WCON-Kunshan
 Tel: +86 512 57468408
 Fax: +86 512 57468468
 E-mail: salesks@wcon.com