

HSF

NOTES:

Rated Current:7.0AMP.
 Contact Resistance:20mΩ Max.
 Withstand Voltage:1000V AC/DC
 Insulation Resistance:1000MΩ Min.
 Operation Temperature:-40°C to +105°C

Contact Material:Brass
 Contact Plating:Au or Sn Over Ni
 Insulator Material:LCP+30%G.F UL94V-0 BK

Recommended P.C.B Layout (Top Side)
 (PCB BOARD TOLERANCE±0.05)

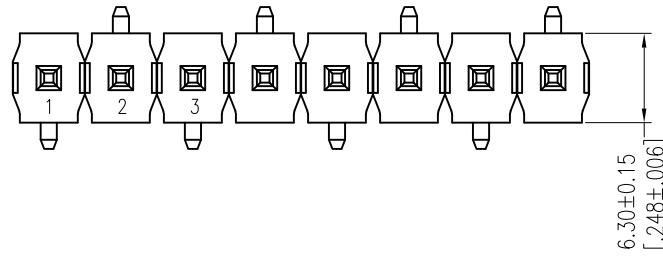

TYPE-1

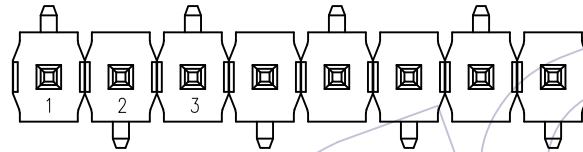
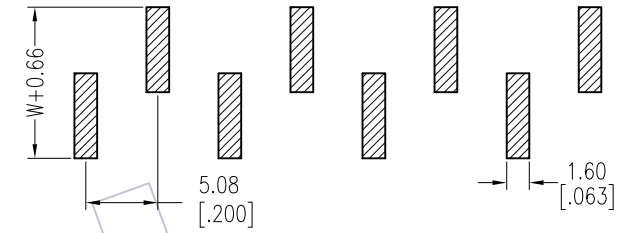

TYPE-2

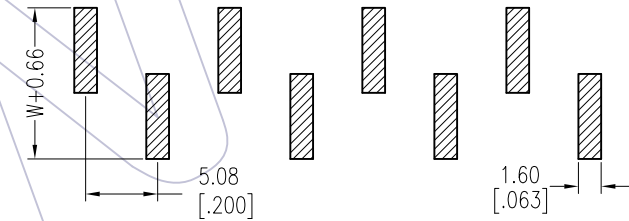

Ordering Information

1925-11 XX XX M XXX D T XX

No.of Pins	Contact Plating	Pin Length	Insulator	Packing	Series No.
02-20	G0=Gold Flash SN=Tin SM=Matte Tin	L=B+D+2.5+ $\frac{W}{2}$ Std:159=15.9	D=LCP	A=Tray T=Tube	01-99

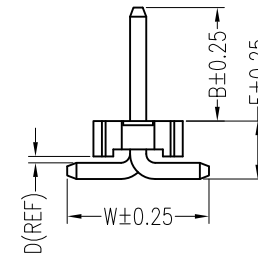
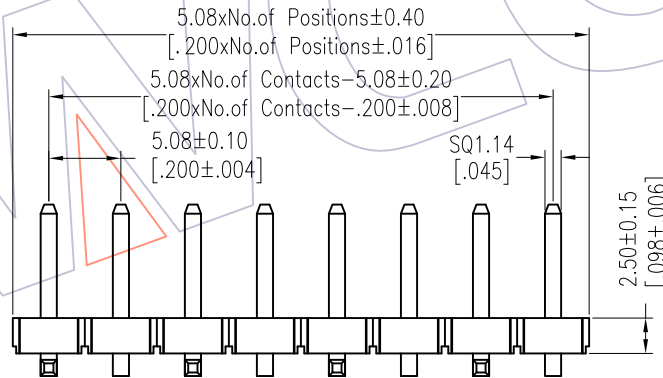

Item	Pin Length	W	E	B	Mating
Standard	15.9	10.00	4.09	8.00	2989
Alternate					

REV	DATE	MODIFICATION DESCRIPTION	CHANGE	OPERATION	DRAW	DATE	SCALE	Fit	PART NO.
				x.X ±0.40	William Chen	2018/01/26	UNIT	mm [inch]	1925-11XXXXMXXDXXX
A1	2018/01/26	MODIFY PART NO.	-----	x.XX ±0.25	CHECK	DATE	SIZE	A4	TITLE:
A0	2012/07/03	NEW	-----	x.XXX ±0.15	APPROVE	DATE	SHEET	1/1	5.08 Pin Header, SINGLE ROW, SMT, H=2.5
				Angle ± 3'			PROJ.		Customer NO.
				DIM TOL					

WCON

Http: www.wcon.com

WCON-Dongguan Tel: +86 769 85358920 Fax: +86 769 85358915 E-mail: sales@wcon.com	WCON-Kunshan Tel: +86 512 57468408 Fax: +86 512 57468468 E-mail: sales@wcon.com
---	--